

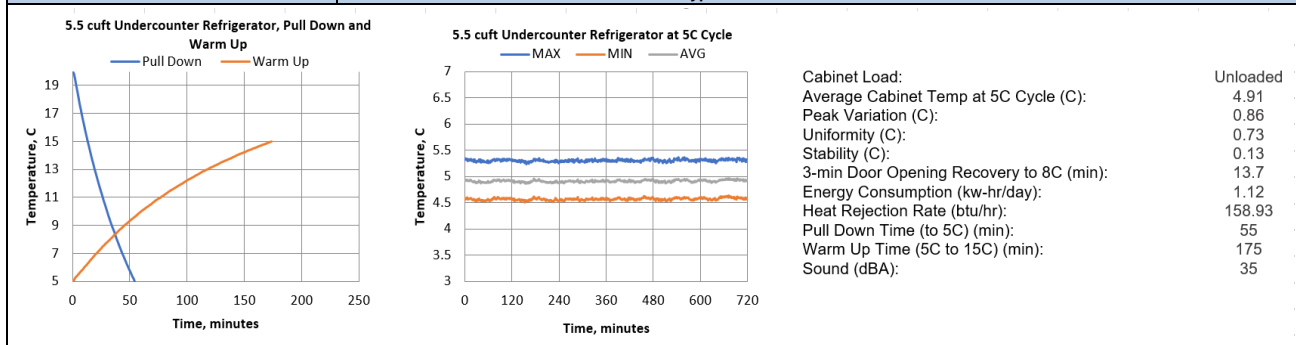

Revision-2

Thermo Fisher Scientific, Asheville, North Carolina

<b>Specifications</b>	<b>Catalog Number</b>	TSG505GA
	<b>Model Number</b>	TSG505GA
	<b>Application, Rating and Electrical Data</b>	
	Application	General Purpose Undercounter Laboratory Grade Refrigerator
Storage Volume	5.5 cu. ft. (156 L)	
Set Point Range/Adjustable in Increments of	+2°C to 9°C / 0.5°C	
Electrical Power	100-240 V, 50-60 Hz	
Instrument Rated Current	3.9 A	
Building Supply Rating	Breaker 15 Amps/100-240 Volt While Operating	
Power Plug/Power Cord Length	NEMA 5-15P, 1.828 Meters (6 Feet)	
Agency Listings	cULus	
Indoor/Outdoor Usage	Indoor Use Only	
Application Environment	Non-Corrosive, Non-Flammable, Non-Explosive, Good Air Ventilation, 10°C - 32°C (50°F - 90°F)	
<b>Refrigeration Configuration</b>		
Refrigeration System	Thermoelectric Based Refrigeration System	
Cooling System	125W Thermoelectric Heat Pump	
Cold Side	Forced Air Design, R744 (CO <sub>2</sub> ) as Refrigerant	
Hot Side	Forced Air Heat-pipe Fin Tube Heat Exchanger with R718 (H <sub>2</sub> O) as working fluid	
Defrost Method	Adaptive Automatic Defrost	
<b>Controller/Electrical System Configuration and Features</b>		
Controller Level	Waist Level	
Power Switch	No	
Controller Type	1.44" LCD non-touch display with separate capacitive touch buttons	
Control Sensor	(1) Air Thermistor	
Display Temperature Sensors	(1) Air Thermistor	
Remote Alarm Terminals	Yes	
Alarms	Yes, Audible and Visual (Temperature Range, Door Ajar, No Power, Battery Low)	
Data Logger	No	
<b>Dimensions and Construction</b>		
Interior Dimensions (H x D x W)	585 mm X 521 mm x 496 mm (23" x 20.5" x 19.5")	
Exterior Dimensions (H x D x W)	813 mm X 661 mm x 600 mm (32" x 26" x 23.6")	
Insulation	VIP, HFC-free Polyurethane Foam	
Door Perimeter Heater	Yes	
Shelves	(3) Adjustable	
Leveling Feet	(4) Adjustable	
Ship Weight	66 kg (145 lbs.)	
Access port	Yes, Rear wall, Accommodates 25 mm probe	



1) Performance is nominal and individual units may vary.  
 2) Refrigerator performance will differ due to product amount, product size and operating conditions.  
 3) Continuous product enhancements may, without notice, result in amendments or omissions to this specification. Thermo Scientific cannot accept responsibility for damage, injury, loss or expenses resulting from misapplication of the information herein.



Typical Cabinet Temperature Map  
Refrigerator 5cuft , 2 Inner-Shelves + Base, Single Outer Door

Temperatures are averages during > 20  
cycles after reaching a setpoint of 5C

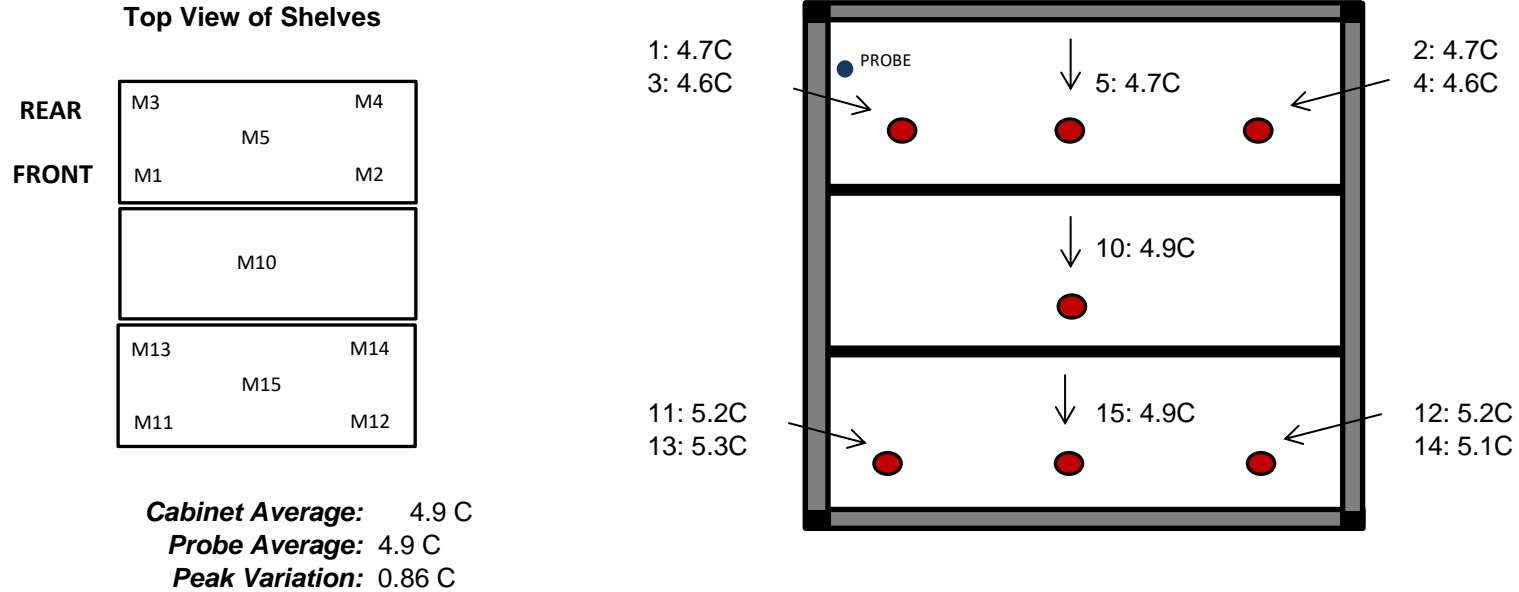

	M1	M2	M3	M4	M5	M10
Avg	4.7	4.7	4.6	4.6	4.7	4.9
Max	4.8	4.8	4.7	4.6	4.8	5
Min	4.7	4.7	4.6	4.5	4.7	4.8

	M11	M12	M13	M14	M15
Avg	5.2	5.2	5.3	5.1	4.9
Max	5.2	5.3	5.4	5.2	5
Min	5.1	5.1	5.2	5	4.9

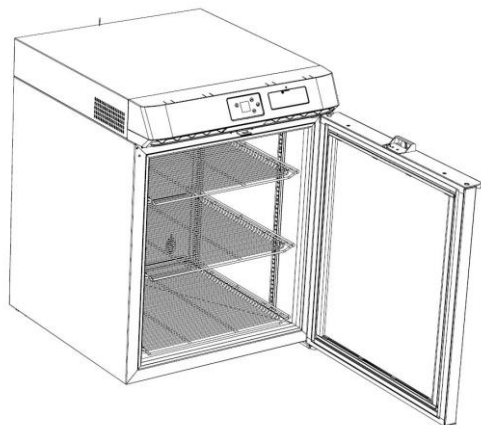

ISOMETRIC VIEW WITH DOOR OPEN

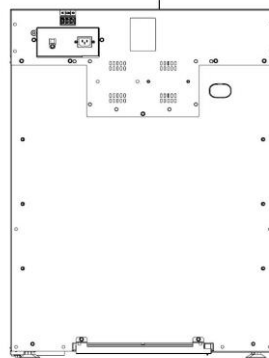

REAR VIEW

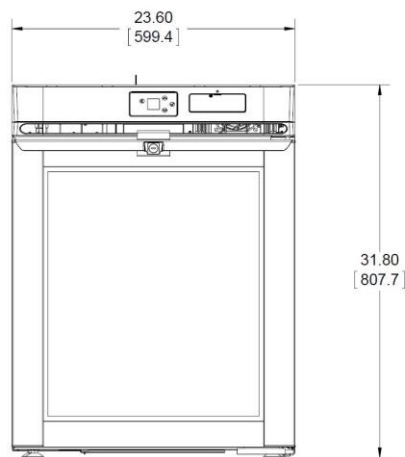

FRONT VIEW

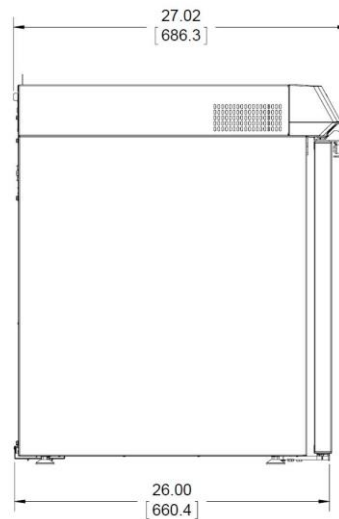

SIDE VIEW